

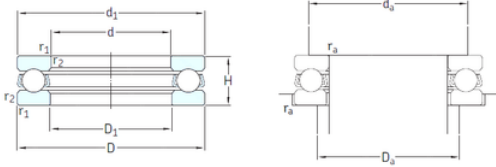

China Abec 5 Bearing Supplier



High Speed SKF Thrust Ball Bearing 51110 SKF Thrust Ball Bearings

Bearing No. 51110

51110 Bearing 2D drawings and 3D CAD models

Size	50x70x14 mm
Bore Diameter	50 mm
Outer Diameter	70 mm
Width	14 mm
d	50 mm
D	70 mm
H	14 mm
d1	70 mm
r1 min.	0,6 mm
r2 min.	0,6 mm
D1	52 mm
da min.	62 mm
Da max.	58 mm
ra max.	0,6 mm
Weight	0,16 Kg
Basic dynamic load rating (C)	27 kN
Basic static load rating (C0)	75 kN
Fatigue load limit (Pu)	2,8
Reference speed	4300 r/min
Limiting speed	6300 r/min
Category	Thrust Ball Bearing
Inventory	0.0
Manufacturer Name	SKF
Minimum Buy Quantity	N/A
Weight / Kilogram	0.167



China Abec 5 Bearing Supplier

EAN	7316576677380
Product Group	B00308
Rolling Element	Ball Bearing
Thrust Bearing	Yes
Single or Double Direction	Single Direction
Banded	No
Cage Material	Steel
Precision Class	ABEC 1 ISO P0
Component Description	Roller Assembly Plus Raceways
Other Features	Single Row
Long Description	50MM Bore 1; 52MM Bore 2; 70MM Outside Diameter; 14MM Height; Ball Bearing; Single Direction; Not Banded; Steel Cage; ABEC 1 ISO P0 Precision
Inch - Metric	Metric
Category	Thrust Ball Bearings
UNSPSC	31171507
Harmonized Tariff Code	8482.10.50.08
Noun	Bearing
Keyword String	Ball Thrust
Manufacturer URL	http://www.skf.com
Manufacturer Item Number	51110
Weight / LBS	0.368
Bore 1	1.969 Inch 50 Millimeter
Outside Diameter	2.756 Inch 70 Millimeter
Height	0.551 Inch 14 Millimeter
Bore 2	2.047 Inch 52 Millimeter
Overall Height with Aligning Washer	0 Inch 0 Millimeter
bore diameter:	50 mm
static load capacity:	75 kN



China Abec 5 Bearing Supplier

outside diameter:	70 mm
dynamic load capacity:	27 kN
overall width:	14 mm
maximum rpm:	6300 RPM
thrust bearing type:	Single-Direction
cage material:	Steel
outside diameter design:	Straight
fillet radius:	0.6 mm
separable or banded:	Separable
series:	511
precision rating:	ABEC 1 (ISO Class Normal)
d_1	70 mm
D_1	52 mm
$r_{1,2}$ min.	0.6 mm
d_a min.	62 mm
D_a max.	58 mm
r_a max.	0.6 mm
Basic dynamic load rating C	27 kN
Basic static load rating C_0	75 kN
Fatigue load limit P_u	2.8 kN
Minimum load factor A	0.029
Mass bearing (including seat washer where applicable)	0.16 kg